

**GALAXY APARTMENT, PREMISES NO-20, KALI LANE, PO & PS-
KALIGHAT, KOLKAT-700026**

Latitude 22° 27' 59" N
Longitude 88° 22' 33.04" E

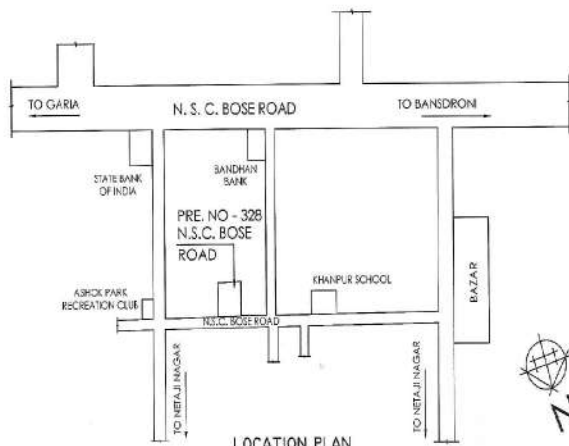

LOCATION PLAN
SCALE-1:4000

Kush Kundu
KUSH KUNDU (D.C.E.)
L.B.S. of K.M.C.
Lic No 1412/1
90E, Jadunath Ukil Road
Kolkata-700 041
SIGNATURE OF L.B.S.

SIGNATURE OF APPLICANT